

WEST SUSSEX COUNTY COUNCIL
((CHICHESTER DISTRICT) (PARKING PLACES AND TRAFFIC REGULATION)
(CONSOLIDATION) ORDER 2010)
(CHICHESTER: SOUTHGATE AND VARIOUS ROADS AMENDMENT) ORDER 2013

CHICHESTER: LOCATION OF WAITING RESTRICTIONS

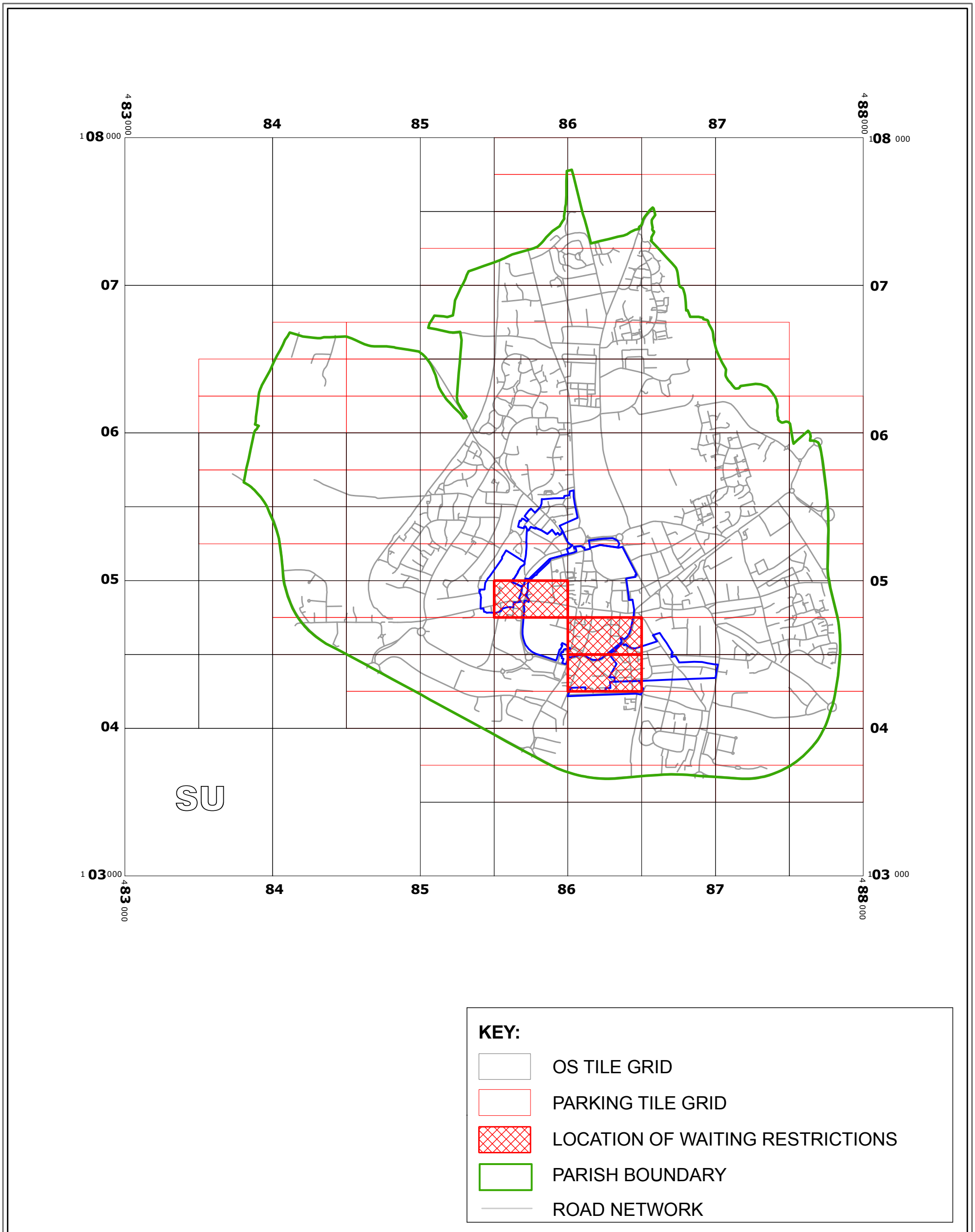

West Sussex County Council
 Infrastructure
 The Grange
 Tower Street
 Chichester
 West Sussex
 PO19 1RH

WEST SUSSEX COUNTY COUNCIL
 ((CHICHESTER DISTRICT)
 (PARKING PLACES AND TRAFFIC REGULATION)
 (CONSOLIDATION) ORDER 2010)
 (CHICHESTER: SOUTHGATE AND VARIOUS ROADS
 AMENDMENT) ORDER 2013
 LOCATION OF WAITING RESTRICTIONS



Reproduced from or based upon 2010 Ordnance Survey mapping
 with permission of the Controller of HMSO (c) Crown Copyright reserved.
 Unauthorised reproduction infringes Crown copyright and may lead
 to prosecution or civil proceedings West Sussex County Council Licence No. 100023447

SCALE: 1:25,000
 08/03/2013

Key for waiting Restrictions

All areas over which the provision of the orders apply are defined by the shaded areas as shown on the following plans plus a contiguous area not indicated on the plans of verge and/or footway between the carriageway edge and the highway boundary. The plans in this schedule are based upon grid references of the Ordnance Survey National Grid defined by the OSGB 36 triangulation.

Prohibition of waiting

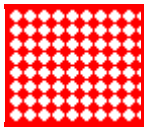
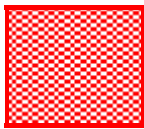
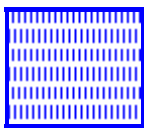
100		z_circle	No waiting, loading and unloading at any time
101		check	No waiting at any time
108		pat 038	No waiting 8.30am-6.00pm Mon-Sat

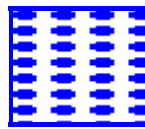
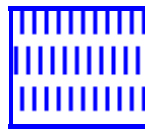
110		pat040	No waiting 9.00am-5.30pm Mon-Sat
111		pat 046	No waiting 9.00am-5.00pm Mon-Sat

Shared Residents Parking & Charged On-street Parking

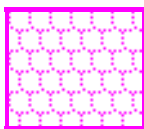
421		shingle	Voucher and Residents' permit holders only 9.00am- 5.30pm Mon-Sat Tariff 1
-----	---	---------	---

Residents Parking

502		dot6	Residents' and Visitors' permit holders only 9.00am-5.00pm Mon-Sat
517		shingle	Residents' permit holders only 9.00am-5.30pm Mon-Sat

Shared Residents Parking & Free Limited Waiting

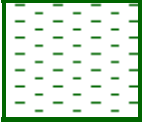
601		pat064	Residents' and Visitors' permit holders and Limited waiting for 1hr No return within 1hr for non-permit holders 9.00am-5.00pm Mon-Sat
-----	---	--------	---

Specified Vehicles

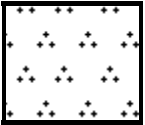
805		historic2	Doctors vehicles 8.30am-6.00pm Mon-Sat
-----	---	-----------	--

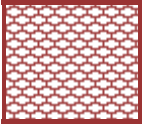
810		usgs503	Loading bay-Goods vehicles only at any time
-----	---	---------	---

830		check	Disabled persons vehicles at any time
-----	--	-------	---------------------------------------

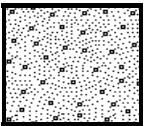
845		usgs602	No waiting at any time except taxis
-----	---	---------	-------------------------------------

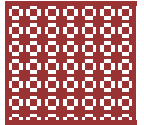
853		pat079	Loading bay-Goods vehicles only 5.00am-8.00pm and Taxi bay 8.00pm-5.00am any day
-----	---	--------	--

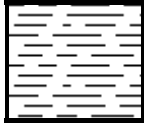
857		pat016	Coaches only at any time maximum stay 30mins
-----	---	--------	--

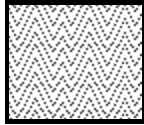
861		herring3	Coaches only at any time maximum stay 15mins
-----	---	----------	--

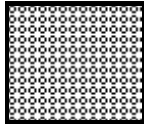
867		circle4	Car club permit holders only 9.00am-5.30pm Mon-Sat
-----	---	---------	--

 Boundary of Controlled Parking Zone

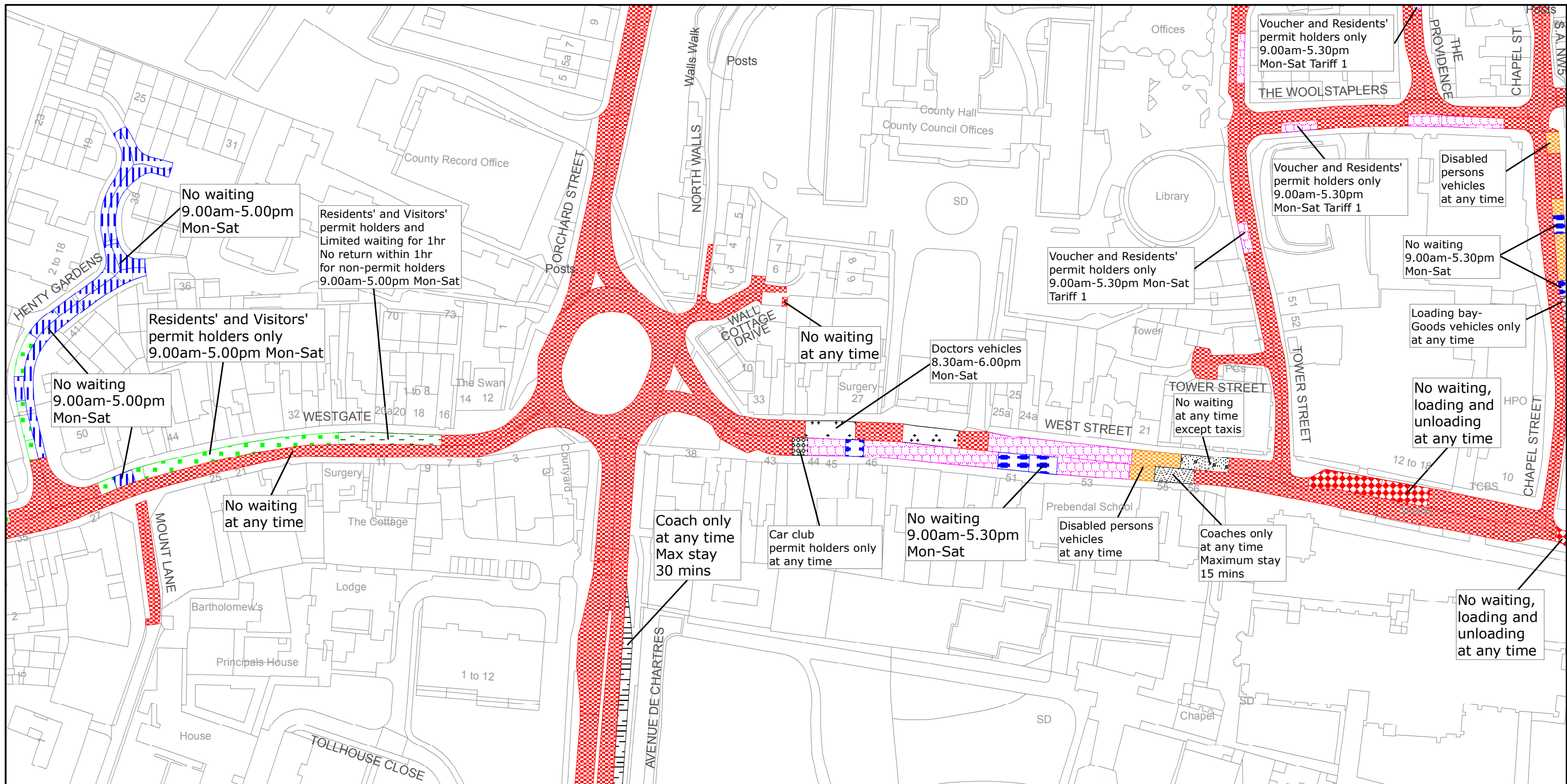

West Sussex County Council
 Communities & Infrastructure
 The Grange
 Tower Street
 Chichester
 West Sussex
 PO19 1RH

CHICHESTER DISTRICT: CHICHESTER
 WAITING RESTRICTIONS

Reproduced from or based upon 2010 Ordnance Survey mapping with permission of the Controller of HMSO (c) Crown Copyright reserved.
 Unauthorised reproduction infringes Crown copyright and may lead to prosecution or civil proceedings West Sussex County Council Licence No. 100018485

TILE REF NO:
 SU8504NEN

SHEET ISSUE NO 3
 SHEET ACTIVE FROM - 08/03/2013

N

 SCALE:
 1:1250
 at A3 size

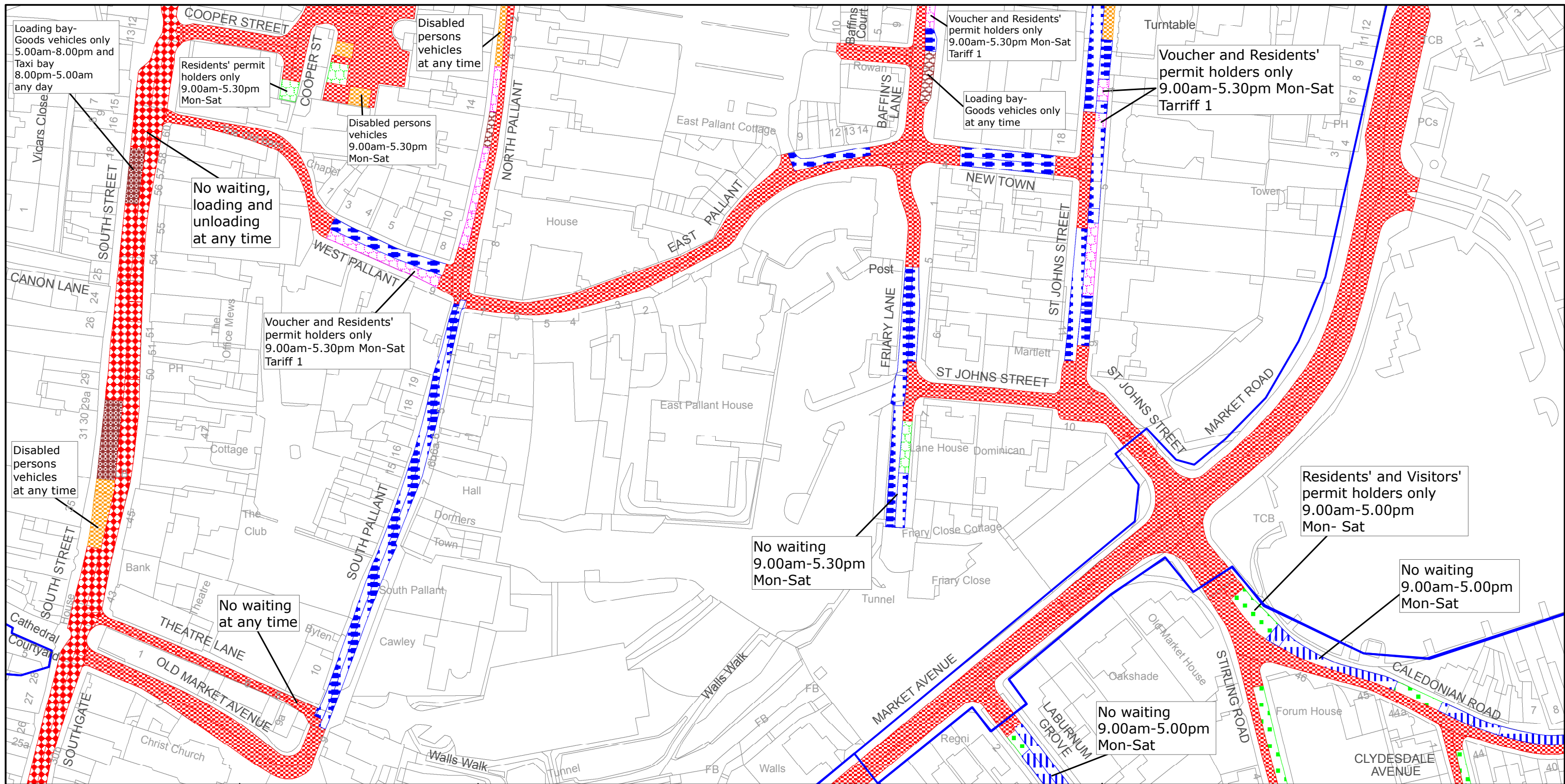

West Sussex County Council
 Communities & Infrastructure
 The Grange
 Tower Street
 Chichester
 West Sussex
 PO19 1RH

CHICHESTER DISTRICT: CHICHESTER
 WAITING RESTRICTIONS

Reproduced from or based upon 2010 Ordnance Survey mapping with permission of the Controller of HMSO (c) Crown Copyright reserved.
 Unauthorised reproduction infringes Crown copyright and may lead to prosecution or civil proceedings West Sussex County Council Licence No. 100018485

TILE REF NO:
 SU8604NWS

SHEET ISSUE NO 2
 SHEET ACTIVE FROM - 08/03/2013

N

 SCALE:
 1:1250
 at A3 size

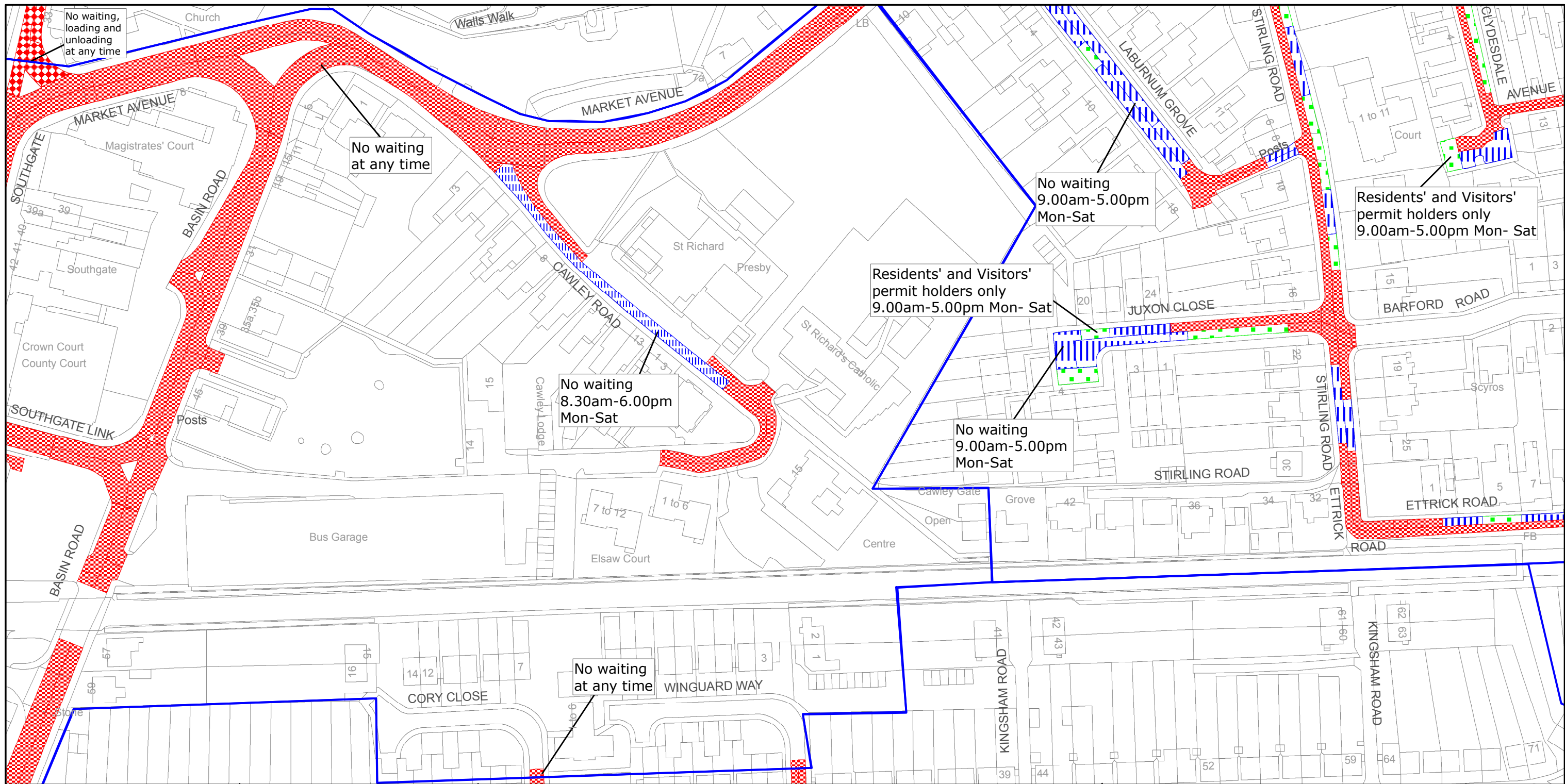

West Sussex County Council
 Communities & Infrastructure
 The Grange
 Tower Street
 Chichester
 West Sussex
 PO19 1RH

CHICHESTER DISTRICT: CHICHESTER
 WAITING RESTRICTIONS

Reproduced from or based upon 2010 Ordnance Survey mapping with permission of the Controller of HMSO (c) Crown Copyright reserved.
 Unauthorised reproduction infringes Crown copyright and may lead to prosecution or civil proceedings West Sussex County Council Licence No. 100018485

TILE REF NO:
 SU8604SWN

SHEET ISSUE NO 2
 SHEET ACTIVE FROM - 08/03/2013



SCALE:
 1:1250
 at A3 size